

Cal. 5030.D

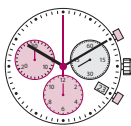

Cal. 5021.D

English User's Manual

Battery type: 395 (diameter 9.5mm x 2.6mm / SR 927 SW)
Accuracy: +20 / -10 seconds per month



Description of the display and control buttons

Display elements

Second hand
Minute hand
Hour hand
Centre stop-second
Minute counter
Hour counter
Date

Control buttons

Push but ton A
Crown
Push but ton B

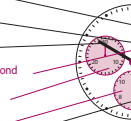

Minute counter Push-but ton A

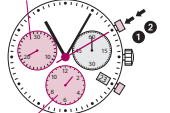

Hour counter



Push-but ton B

Chronograph: Basic function

(Start / Stop / Reset)

Example:

- Start: Press push-but ton A.
- Stop: to stop the timing, press push-but ton A once more and read the three chronograph hands: **1h / 20min / 10 sec.**
- Zero positioning: Press push-but ton B. (The three chronograph hands will reset to their zero positions).

Minute counter Push-but ton A



Hour counter



Push-but ton B

Chronograph: Accumulated timing

Example:

- Start (start timing)
- Stop: (e.g. 15 min 5 sec following 1)
- Restart: (timing is resumed)
- Stop: (e.g. 13 min 5 sec following 3)
= 28 min 10 sec
(The accumulated measured time is shown)

- Reset: The three chronograph hands are returned to their zero positions.

Please note:
* Following 5, the accumulation of the timing can be continued by pressing push-but ton A (Restart / Stop, Restart / Stop, ...)



Minute counter Push-but ton A



Hour counter

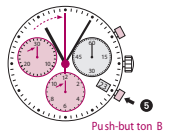

Push-but ton B

Chronograph: Intermediate or interval timing

Example:

- Start: (start timing)
- Display interval: e.g. 10 minutes 10 seconds (timing continues in the background)
- Making up the measured time: (the three chronograph hands are quickly advanced to the ongoing measured time)
- Stop: (Final time is displayed)
- Reset: The three chronograph hands are returned to their zero position

Please note:
* Following 5, further intervals or intermediates can be displayed by pressing push-but ton B (display interval / make up measured time, ...)

Minute counter Center stop-second

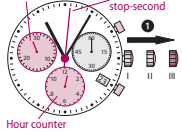

Hour counter

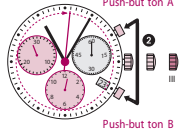

Push-but ton B

Adjusting the chronograph hands to zero position

Example:
One or several chronograph hands are not in their correct zero positions and have to be adjusted (e.g. following a battery change).

- Pull out the crown to position III (all 3 chronograph hands are in their correct zero position).
- Keep push-but tons A and B depressed simultaneously for at least 2 seconds (the centre stop-second rotates by 360° → corrective mode is activated).

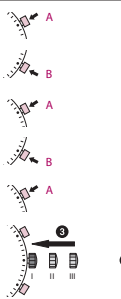

Adjusting the centre stop second

Single step: A 1 x short

Continuous: A long

Adjusting the next hand: B

Adjusting the hour counter hand (position 6h)

Single step: A 1 x short

Continuous: A long

Adjusting the next hand: B

Adjusting the minute counter hand (position 9h)

Single step: A 1 x short

Continuous: A long

- Returning the crown to position I
Termination of the chronograph hands adjustment (can be carried out at any time).

Second hand

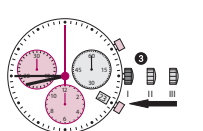
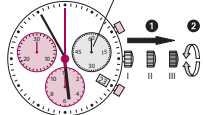

Setting the time

- Pull out the crown to position III (the watch stops).
- Turn the crown until you reach the correct time 8:45.
- Push the crown back into position I.

Please note:
* In order to set the time to the exact second, must be pulled out when the second hand is in position ± 50 (I).
Once the hour and minute hands have been set, must be pushed back into position I at the exact second.



Setting the date (quick mode)

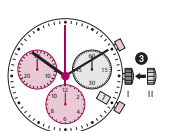
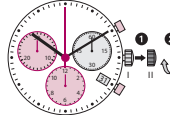

- Pull out the crown to position II (the watch continues to run)
- Turn the crown until the correct date appears.
- Push the crown back into position I.

Please note:
During the date changing phase between 9 PM and 12 PM, the date must be set to the date of the following day.

Crown

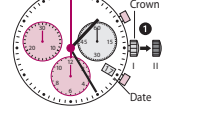

Setting the date/time following a battery change

Example:
- Date / time on the watch: 17 / 125 AM
- Present date / time: 4 / 8:30 PM

- Pull out the crown to position II (the watch continues to run).
- Turn the crown until yesterday's date appears [1].

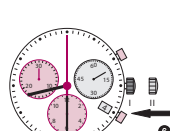
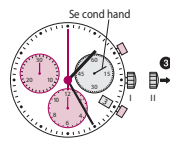

- * Pull out the crown to position III (the watch stops).
- ** Turn the crown until the correct date [2] appears.
- ** Continue to turn the crown until the correct time 8:30 PM appears.
- ** Push the crown back into position I.

Please note:
* To set your watch to the exact second, please refer to the chapter entitled "Setting the time".
** Please observe the AM/PM clock rhythm.